



■ **Maquiasfalt S.L.**  
Madrid

■ **Arvel Industries Sarl**  
Coudes

■ **Giletta SpA**  
Revello (CN)

■ **Bucher Municipal**  
Niederweningen

■ **Gmeiner GmbH**  
Wernberg-Köblitz

■ **Bucher municipal LLC**  
Kaluga

BMU\_LI\_EN\_rev03 - 04/2018 - The technical data and pictures are indicative and not binding.

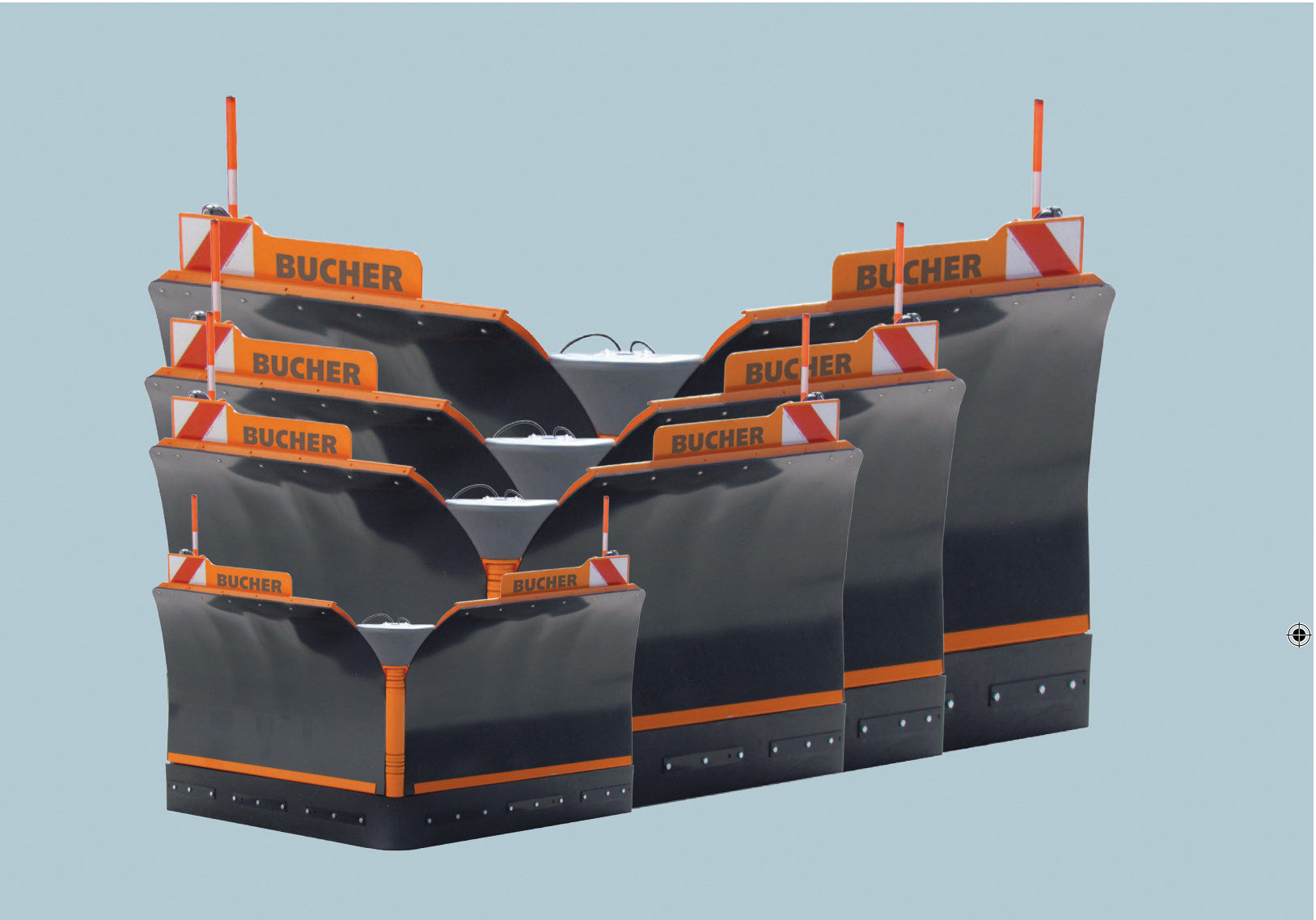

**BUCHER**  
municipal

Convertible snow plough

**Giletta SpA**  
Via A. De Gasperi, 1  
I - 12036 Revello (CN)  
tel. +39 0175 258 800  
fax. +39 0175 258 825  
giletta@buchermunicipal.com

[www.buchermunicipal.com/winter](http://www.buchermunicipal.com/winter)

**Unix**  
Universal snow plough



Unix US, UR, UL ed UM

The Unix range snow plough will revolutionize your work methods, thanks to the combination of the advantages of a one-side plough to the versatility of a variable v-plough concerning both working speed and safety.

This equipment it's best suited for urban snow clearing, also with high snow falls, where it's normal work with difficult pavements as cobblestone, it's frequent the presence of obstacles and it's necessary to adapt to many situation.

- One-side plough configuration:** the shape of the mouldboard, combined with the override protection, allow a safe high speed working with the optimal comfort of a standard plough.
- Wedge plough configuration:** the high and open profile of the mouldboard enable an excellent evacuation from the outline, making it suitable for re-opening a road or widen a snow bank on road side. It is also ideal to operate in narrow passages.
- Shovel plough configuration:** this configuration it's perfect to clean parking lots, squares or in every case it is not possible clear aside the snow, as in presence of narrow passages, crossroads or private driveway.

A Unix snow plough shows every benefit of a variable geometry plough thanks also to NEOTECH 2S, the single-segment flexible scraper blade made from neoprene "HD bi-shore".

This scraper blade features many advantages due to its flexible nature, such as the ability to clear road whit uneven profile, a low level of noise and vibrations emission and an exceptional working life.

All this qualities, combined with the negative attack angle, ensures the override protection; while the hydraulic system it's prepared to absorb the lateral shocks enabling a safe driving in every configuration.

The Unix range includes different size (US, UR, UL e UM) that could be installed on light duty vehicle, tractors, wheel loaders up to heavy duty truck, implement carriers or tractor with more than 200 hp.

All the main quick change interface standards are available and it's also possible made it on customers specifics.

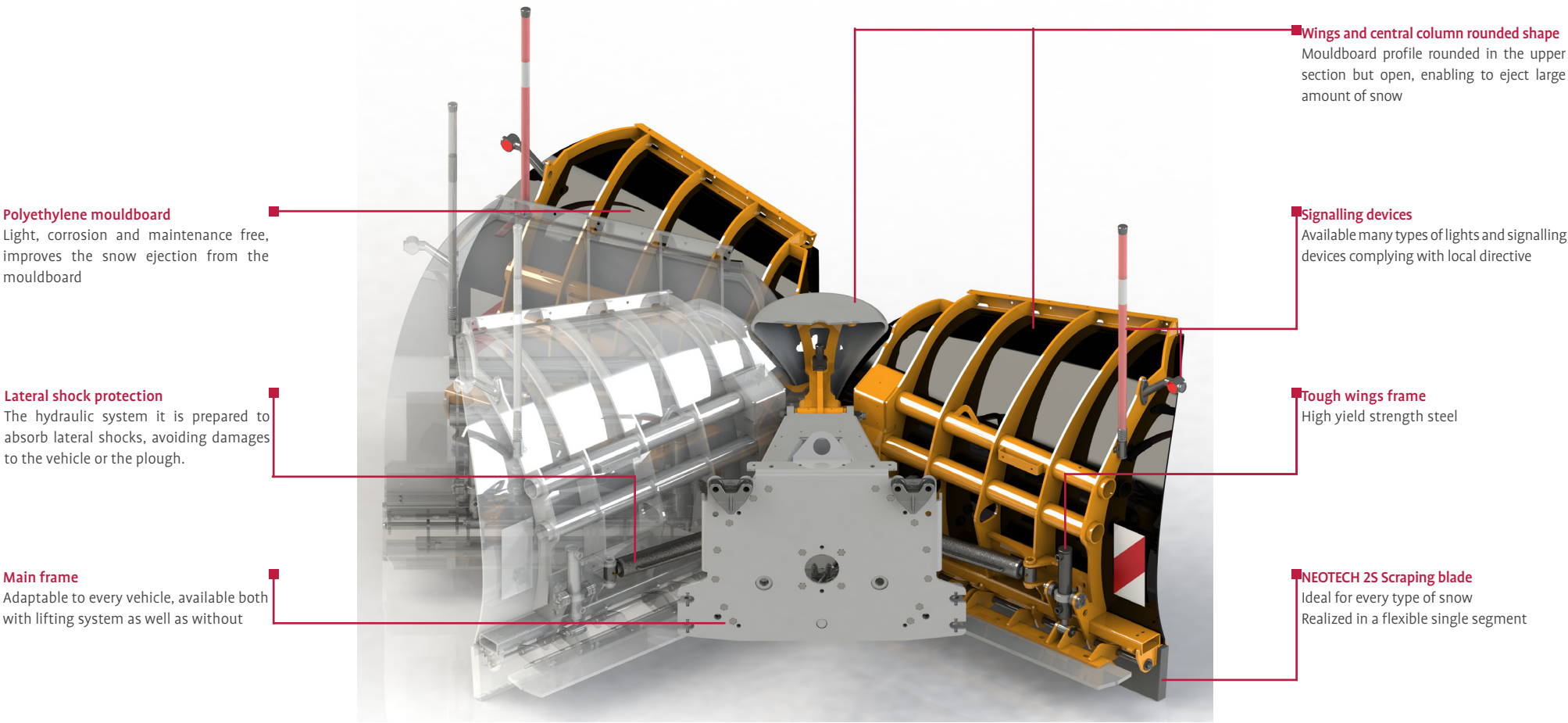

**Lateral tilting system**  
Lateral tilting system which enables to follow the road profile thanks to 14° of free movement (+/- 7°). Hold the plough parallel to the ground when lifted.



**Work configuration**  
The particular central column includes the hinge that allow to each wing to assume every position between -40° , in wedge configuration, and +32° in shovel configuration.  
CONFIGURATION A: **one-side**  
CONFIGURATION B: **wedge**  
CONFIGURATION C: **shovel**

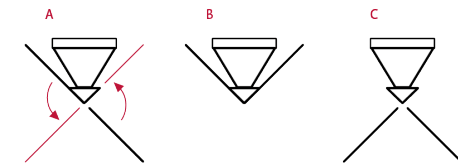

Both the configuration with double and single scraping blade as well allow to adjust the clearing angle in every intermediate position without interference.



Second scraping blade

The equipment it is prepared to have two scraping blade, with electro-hydraulic control from the operator seat, ensure adaptability and immediate effectiveness.



Duplicator/Tripler valve

Allow to use an hydraulic system that don't have all the necessary function lines



Electro-hydraulic unit

Allow to install the equipment on a vehicle without hydraulic system, powering the unit from the vehicle battery



Lateral protection

Ideal to work close to the new-jersey and to help the ejection



Scraping blade lateral protection

Save the scraping blade when it is necessary to work close to sidewalks or walls

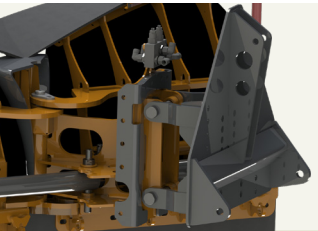

Agricultural quick change

Best suited on tractors equipped with lifting system and three point quick coupling

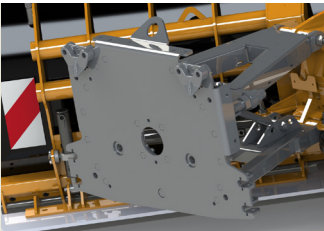

Quick change with lifting

Best suited on tractors equipped with lifting system and quick change interface plate

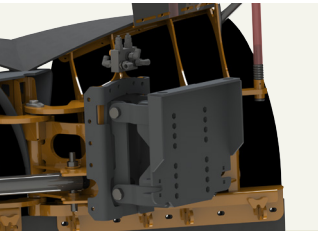

Quick change without lifting

Best suited on tractors equipped without lifting system and quick change interface plate